

CODING TABLE

Body	Actuator
A4120-2.00EFGMG300CSCSTE0017T	M4700-300STCI

Model	
A4 Series 120	A-4120

Size	
INCH	0.50-8.00

Body Form	
Three-Flange Body	E

Form of Connection	
Flange acc. to ASME B16.5	RF F* SW S BW B

Bonnet Form	
Without Pressure Balancing	G

Bonnet Assembly	
Standard Bonnet	M
Extended Bellow Seal	E

Packing Box	
PTFE Rings with Graphite	P
Pure Graphite-Rings	G

Pressure Range	
Class	300

Body Material	
WCB Carbon Steel	CS
CF8M Stainless Steel	SS

Plug	
Contoured Plug	C
Disc Plug	D

Plug Type	
Standard	S
Soft Seated	X
Stellited	Y

Plug Guidance	
Top Guide	T

Characteristic	
Equal Percentage	E
Linear	L
On-Off	O

Accessories	
(Choose one or more)	-
None	D
Solenoid (24VDC)	U
Solenoid (110VAC)	E
Limit Switch Box	L
SRP981 Pneumatic Pos.	P
SR1986 Conventional Pos.	C
SRD998 Intelligent Pos.(Hart)	I
Communication Profibus**	R
Comm. Foundation Fieldbus**	T
Position Feedback	F
Air Set	S
By Pass/Drain Valve connection with plug	B
Steel, chromatised tubing for positioner	X
Stainless steel tubing for positioner	Y
Other (specify)	O

Fail Positioner	
Close	C
Open	O

Hand Wheel	
Without	W
Top Mounted	T

Spring Ranges	
2.9 – 14.5 psig	R
7.2 – 27.5 psig	S
14.5 – 29 psig	Z
17.4 – 34.8 psig	Y
21.7 – 43.5 psig	K
21.7 – 55.1 psig	B
34.8 – 69.6 psig	X

Actuator Size cm² (in²)	
M4700	300 (46.5)
Pneumatic	450 (69.75)
Actuator	700 (108.5)
	1400 (217)

Actuator Model	
Pneumatic Actuator	M4700
Electrical Actuator**	M4800

Trim Material	
SS-316Ti	T

Cvs Value	0.17-632.3
------------------	------------

Flow Tends to Open Valve	O
Flow Tends to Close	C

* ANSI 150 drilling possible.
** Please consult factory.

> We are continuously improving our products.
> Indycan reserved the right to modify the valve specifications without notice.
> Specifications stated in this document is believed to be accurate, however they are for general information purposes only and may not be used as guaranteed values.
> Final responsibility for selection, installation, operation, safety and maintenance of Indycan valves belongs to the user/owner.



12 Greenhead Road, Huddersfield,
West Yorkshire, HD1 4EN.
Phone: +44 7810 833309

www.indycan.com



A4 SERIES 120

ANSI Class 300

Sizes 1/2"-8"



INDYCON SERIES 120

A NEW CONTROL VALVE DESIGNED
FOR LONG TERM RELIABILITY.



INDYCON SERIES 120
SO RELIABLE YOU COULD
FORGET WHERE, WHEN,
HOW IT WORKS.

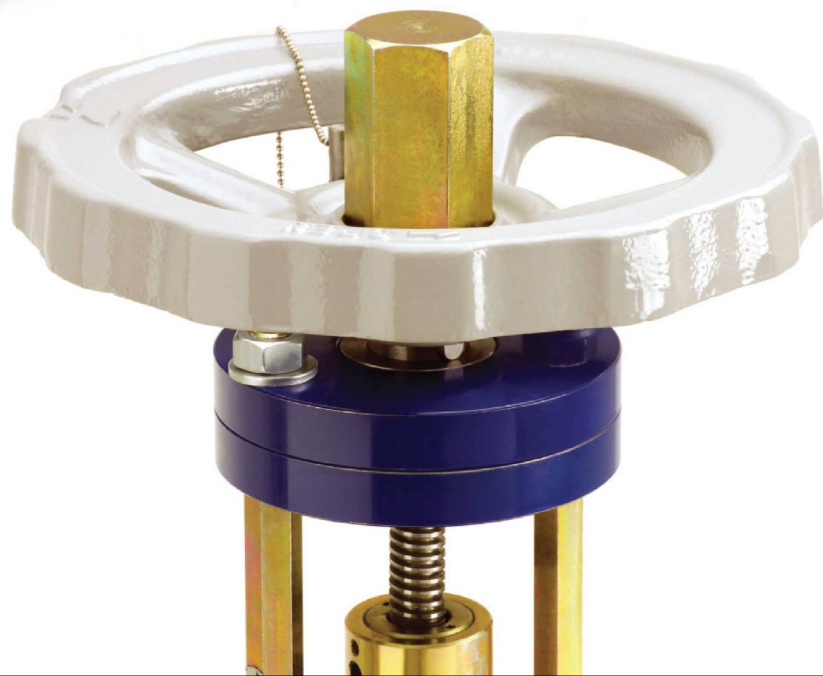

INDYCON SERIES 120
DIFFERENT SOLUTIONS
FOR DIFFERENT NEEDS



WITHOUT FOXBORO Series 900		INDYCON Mark IV Series	
Positioner	<input type="checkbox"/>	Body	
Tag No.		Temp. / Pressure	
DN / PN		Actuator Area	
K vs		Air Supply min./max.	
Seat	<input type="checkbox"/>	Spring Range	
		Stroke	
		Foil Position	
		Delta Pressure	
		Serial No.	

INDYCON SERIES 120
START SAVING FROM
THE FIRST DAY ON.

- Signal
- Indycon
- Others

SMALLER VALVE
SIZE FOR A GIVEN
APPLICATION

- > Highest possible seat diameter (Valve size=Seat Ø)
- > High throttling rangeability
- > Longest possible stroke

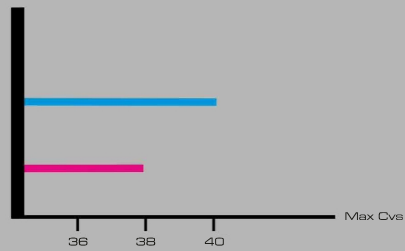

BETTER
CONTROL
QUALITY

- > Excellent plug geometry
- > Widest controllability range
- > High technology positioner
- > Fast response

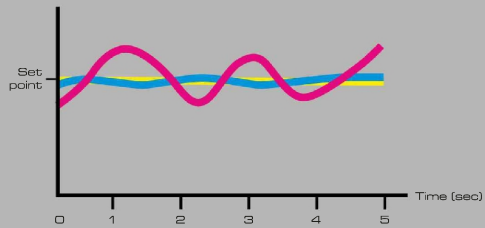

BETTER STEP
RESPONSE

- > Agile actuator
- > Precise positioning accuracy
- > Very low friction

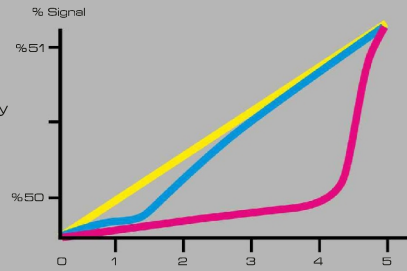

FASTER
SET UP

- > User friendly
- > No special tool needed
- > Auto tune, Fieldbus functionality
- > Easy calibration with single pushbutton
- > Self diagnostic function
- > Supply air pressure up to 87 psi for fast movement

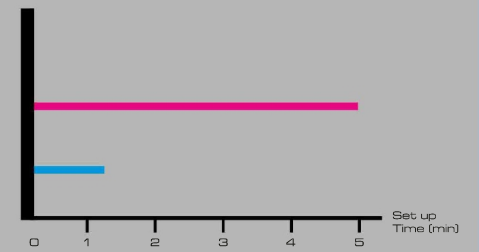

COMPONENTS

ACTUATOR

- Reliable, powerful actuator system for accurate valve positioning.
- High actuation force generated by maximum (90 psi) 6 bar air.
- Compact dimensions due to multi spring.
- Fast, agile response due to minimized air volume.
- High ambient temperature (185°F/85°C)
- Guided movement of stem for high stability.
- Membrane with kevlar fabric reinforcement for long life, high accuracy, linearity.
- Virtual maintenance free design.
- Optional manual hand wheel system.

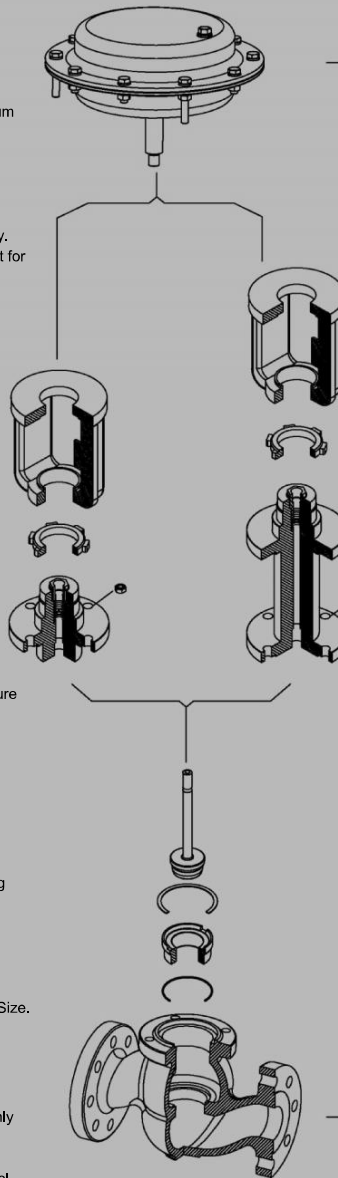

WIDE RANGE OF APPLICATIONS

- For accurate control of gas, vapour, liquid, pressure, flow and temperature.
- Combined with the Foxboro positioner INDYCON valve offers precise control characteristic. Optional Foxboro positioners with HART, PROFIBUS, FOUNDATION, FIELDBUS communication protocols ensures trouble free systems.
- Having a modular design INDYCON valve offers various application possibilities.

YOKE

- Robust yoke construction for reliability.

BONNETS

- Quality and Durability for the long run.
- Sturdy dual guided plug steam structure (thanks to the secondary guide) ensuring vibration free operation.
- Maintenance free packing box with spring loading.
- Choice of bonnets for standard or high temperature.
- Pressure up to 580 psi (40 bar). Temperature up to 662 °F.
- Low internal friction.

INHERENT ADVANTAGES

- Space efficient overall height and dimensions.

PROMPT DELIVERY

- Almost all sizes of INDYCON Control Valves can be delivered within a week.

TRIM

- Multi application versatility.
- Mostly interchangeable trims.
- All bellows types use the same/similar plug stem type.
- Easily replaceable trim.
- Simple maintenance as the valve body remains in the piping when trim is replaced. Screwed seat easily replaceable.
- Large flow capacity, max. Seat ϕ = Valve Size.

RELIABLE

- Heavy duty construction with high quality materials and workmanship.

BODY

- Optimum flow characteristics due to smoothly engineered body.
- Large kvs values.
- Excellent flow dynamics and built in control quality.

QUALITY

- Quality assurance system of production certificated acc.TUV Management Service ISO 9001:2000.

VALVE SELECTION

Packing Box

Type of Packing	Standard Bonnet		Bellows seal Bonnet	
	PTFE V-Rings + Graphite spring	+14°F +464°F, maintenance free	•	•
Pure Grafite-Rings	+14°F +662°F.	•	•	•

Form of Connection, Nominal Pressure Range

Form of Connection	ANSI Class	Nominal Size INCH											
		1/2	3/4	1	1 1/4	1 1/2	2	2 1/2	3	4	6	8	
Connection Face Type acc. to ASME B16.34	RF	•	•	•	•	•	•	•	•	•	•	•	•
	BW	•	•	•	•	•	•	•	•	•	•	•	•
	SW	•	•	•	•	•	•	•	•	•	•	•	•

Pressure-Temperature Ratings acc. to ASME B16.34

CLASS (lb)	Body Material	Service Temperature in °F	-20 ~ 100	200	300	400	500	600	650	700	750	800
300	WCB	Working Pressure in Psi	741	675	655	635	600	550	535	535	505	410
	CF8M		720	620	560	515	480	450	445	430	425	415

Leakage-class acc. to ANSI/FCI 70-2-1991

Line Pressure Balancing	Plug Design	Leakage-class acc. ANSI/FCI 70-2	Test Medium	Test Pressure (psi)	max. Seat Leakage in % of kvs
Unbalanced	metal to metal seated	IV	Water	Working Pressure, max.58	0.01
	soft seated	VI	Air	Working Pressure, max.58	0.0-bubble-tight

Contoured Plug

Modified-equal percentage or linear

¹ Only for modified-equal percentage !

Cvs (gpm)	Seat ϕ	Standard	Incorporable seat diameter depends on nominal size INCH													
			1/2	3/4	1	1 1/4	1 1/2	2	2 1/2	3	4	6	8			
			Stroke = 0.8"													
0.17	0.16 ¹	•	•	•	•	•	•	•	•	•	•	•	•	•	•	•
0.28	0.16 ¹	•	•	•	•	•	•	•	•	•	•	•	•	•	•	•
0.45	0.16 ¹	•	•	•	•	•	•	•	•	•	•	•	•	•	•	•
0.71	0.24 ¹	•	•	•	•	•	•	•	•	•	•	•	•	•	•	•
1.10	0.28 ¹	•	•	•	•	•	•	•	•	•	•	•	•	•	•	•
1.80	0.31 ¹	•	•	•	•	•	•	•	•	•	•	•	•	•	•	•
2.85	0.39 ¹	•	•	•	•	•	•	•	•	•	•	•	•	•	•	•
4.50	0.47	•	•	•	•	•	•	•	•	•	•	•	•	•	•	•
6.35	0.63	•	•	•	•	•	•	•	•	•	•	•	•	•	•	•
9.25	0.63	•	•	•	•	•	•	•	•	•	•	•	•	•	•	•
11.8	0.79	•	•	•	•	•	•	•	•	•	•	•	•	•	•	•
12.6	0.79	•	•	•	•	•	•	•	•	•	•	•	•	•	•	•
17.6	0.98	•	•	•	•	•	•	•	•	•	•	•	•	•	•	•
21.1	0.98	•	•	•	•	•	•	•	•	•	•	•	•	•	•	•
29.5	1.34	•	•	•	•	•	•	•	•	•	•	•	•	•	•	•
30.1	1.34	•	•	•	•	•	•	•	•	•	•	•	•	•	•	•
37.9	1.57	•	•	•	•	•	•	•	•	•	•	•	•	•	•	•
43.7	1.65	•	•	•	•	•	•	•	•	•	•	•	•	•	•	•
52.0	1.97	•	•	•	•	•	•	•	•	•	•	•	•	•	•	•
70.4	2.09	•	•	•	•	•	•	•	•	•	•	•	•	•	•	•
89.1	2.64	•	•	•	•	•	•	•	•	•	•	•	•	•	•	•
102	2.64	•	•	•	•	•	•	•	•	•	•	•	•	•	•	•
128	3.15	•	•	•	•	•	•	•	•	•	•	•	•	•	•	•
176	3.31	•	•	•	•	•	•	•	•	•	•	•	•	•	•	•
198	3.94	•	•	•	•	•	•	•	•	•	•	•	•	•	•	•
278	4.13	•	•	•	•	•	•	•	•	•	•	•	•	•	•	•
397	5.12	•	•	•	•	•	•	•	•	•	•	•	•	•	•	•
476	5.90	•	•	•	•	•	•	•	•	•	•	•	•	•	•	•
635	7.87	•	•	•	•	•	•	•	•	•	•	•	•	•	•	•

ACTUATOR SELECTION

Multi-Spring Actuator M4700 (Spring to close)

Typical ranges for Series 120 Valve

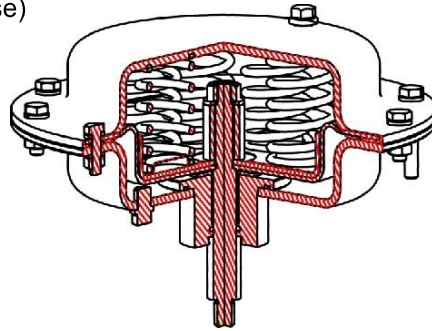

Effective area		Air Supply	Spring Ranges
(cm ²)	(in ²)	(psi)	(psi)
300	46.5	42	17-35
		80	35-70
50	69.75	42	17-35
		80	35-70
700	108.5	42	17-35
		80	35-70
1400	217	42	17-35
		80	35-70

Actuator Selection for:

Operation: Spring to close

Flow: Tends to open Valve, without Pressure Balancing, p=0

Packing Box: Pure Graphite-Rings

Bonnet: Standard –Bonnet

max.differential pressure in psi actuator selection

Sitz	Valve Size	Effective area	(cm ²)	300		450		700		1400	
			(in ²)	46.5		69.75		108.5		217	
		Spring Ranges	(psi)	17-35	35-70	17-35	35-70	17-35	35-70	17-35	35-70
Ø		Air	(psi)	42	80	42	80	42	80	42	80
0.24	1/2", 3/4", 1"	Stroke 0.8"		580	580						
0.31				580	580						
0.39				580	580						
0.47				580	580						
0.63			1/2", 3/4", 1", 1 1/4"	580	580						
0.79	3/4", 1", 1 1/4", 1 1/2"	580	580								
0.98	1", 1 1/4", 1 1/2", 2"	580	580								
1.34	1 1/2", 2"	450	580								
1.57	1 1/2"	319	464								
1.65	2"	290	421								
1.97		189	290								
1.65	2 1/2"	Stroke 1.6"			580	580	580	580			
2.09	2 1/2", 3"				392	551	580	580			
2.64	3", 4"				232	334	363	508			
3.15	3"				160	232	247	348			
3.31	4"				145	203	218	319			
3.94	4"	Stroke 1.8"			102	145	160	218			
5.12			6"					-	74	74	192
7.87	8"	Stroke 3.1"						148*	177*	311*	355*

*Double acting configuration.

ACTUATOR SELECTION

Multi-Spring Actuator M4700 (Spring to open)

Typical ranges for Series 120 Valve

Effective area		Air Supply	Spring Ranges
(cm ²)	(in ²)	(psi)	(psi)
300	46.5	51	3-14.5
		80	3-14.5
450	69.75	51	3-14.5
		80	3-14.5
700	108.5	51	3-14.5
		80	3-14.5
1400	217	51	3-14.5
		80	3-14.5

Actuator Selection for:

Operation: Spring to open

Flow: Tends to open Valve, without Pressure Balancing, p=0

Packing Box: Pure Graphite-Rings

Bonnet: Standard –Bonnet

max.differential pressure in psi actuator selection

Sitz	Valve Size	Effective area	(cm ²)	300		450		700		1400	
			(in ²)	46.5		69.75		108.5		217	
		Spring Ranges	(psi)	3-14.5	3-14.5	3-14.5	3-14.5	3-14.5	3-14.5	3-14.5	3-14.5
Ø		Air	(psi)	51	80	51	80	51	80	51	80
0.24	1/2", 3/4", 1"	Stroke 0.8"		580	580						
0.31				580	580						
0.39				580	580						
0.47				580	580						
0.63			1/2", 3/4", 1", 1 1/4"	580	580						
0.79	3/4", 1", 1 1/4", 1 1/2"	580	580								
0.98	1", 1 1/4", 1 1/2", 2"	580	580								
1.34	1 1/2", 2"	580	580								
1.57	1 1/2"	580	580								
1.65	2"	551	580								
1.97		377	580								
1.65	2 1/2"	Stroke 1.6"			580	580	580	580			
2.09	2 1/2", 3"				580	580	580	580			
2.64	3", 4"				435	580	580	580			
3.15	3"				305	522	450	580			
3.31	4"				276	464	406	537			
3.94	4"	Stroke 1.8"			189	319	276	377			
5.12			6"					105	225	255	480
7.87	8"	Stroke 3.1"						-	90	105	195

POSITIONER SYSTEM

Product Features

SRP981 Pneumatic Positioner

- Independent adjustment of stroke range and zero
- Low vibration effect in all directions
- Supply pressure up to 90 psig
- Single or double-acting
- Mounting according to IEC 534, part 6 (NAMUR)
- Connection Manifold optional
- Booster optional

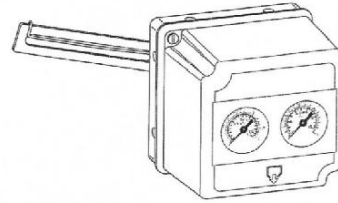

SRP 981 PNEUMATIC POSITIONER

SRI986 Conventional Positioner

- Independent adjustment of stroke range and zero
- Adjustable amplification and damping
- Split range up to 3-fold possible
- One version for 0 to 20 mA and 4 to 20 mA input
- Supply pressure up to 90 psig
- Explosion protection: EEx ia IIC T6 acc. to ATEX or "Intrinsic safety" acc. to FM and CSA
- Low vibration effect in all directions
- Mounting according to IEC 534, part 6 (NAMUR)
- Rotation adapter for angles up to 120°
- Optional position feedback
- Protection Class: IP54, Optional IP65

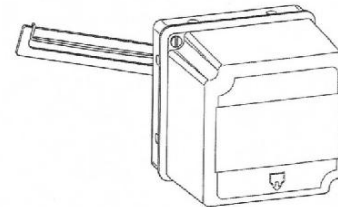

SRI 986 ELECTRO PNEUMATIC CONVENTIONAL POSITIONER

SRD998 Intelligent Positioner with HART Communication

- Auto-start with self-calibration
- Self diagnostics, status- and diagnostic messages
- Easy local operation with the rotary selector
- Extra-large Multi-Lingual full text graphical LCD
- VALcare™ DTM with comprehensive data for fast configuration
- With HART 7 communication
- Stroke 8 to 260 mm (0.3 to 10.2 in) with standard lever; larger stroke with special lever
- Angle range up to 95° angle
- Mounting onto any linear or rotary actuator
- Supply air pressure up to 6 bar (90 psig)
- Single or double-acting
- Protection class IP 66 and NEMA 4X
- Explosion protection: Intrinsic Safety according to ATEX / IECEx, INMETRO, NEPSI, ...

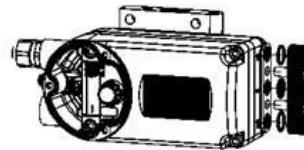

SRD998 INTELLIGENT POSITIONER with HART COMMUNICATION

Airset

- Max. Supply pressure up to 145 psi
- Output range 4.3 – 145 psi
- Filter 5 pm
- Manually operated drain
- With gauge

Tubing

- 0.24in non-metallic tubing standard
- Steel, chromatised
- Stainless steel

Other positioners available upon request.

ACTUATOR TECHNICAL DATA

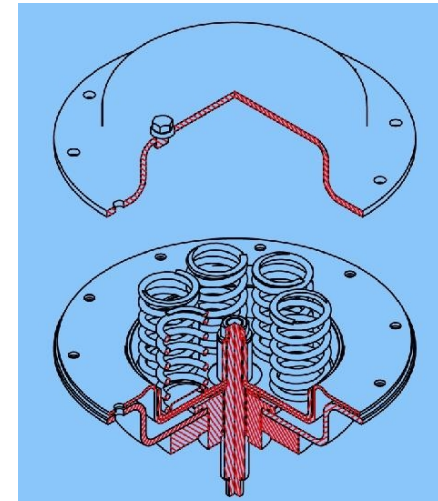

Technical Details

Actuator Size		Stroke (in)	Spring Range (psi)	Stem extends by air failure		Stem retracts by air failure	
(cm ²)	(in ²)			Minimum Air Supply (psi)	Spring to Close Maximum Force (N)	Minimum Air Supply (psi)	Spring to Open Maximum Force (N)
300	46.5	0.8"-1.6"	3-14.5	17	600	90	15000
			7-28	30	1500	90	-
			14.5-29	32	3000	90	-
			17-35	38	3600	90	-
			22-44	46	4500	90	-
			22-55	58	4500	90	-
450	69.75	1.6"-1.8"	3-14.5	17	900	90	22500
			7-28	30	2250	90	-
			14.5-29	32	4500	90	-
			17-35	38	5400	90	-
			22-44	46	6750	90	-
			22-55	58	6750	90	-
700	108.5	1.6"-2.7"	3-14.5	17	1400	90	35000
			7-28	30	3500	90	-
			14.5-29	32	7000	90	-
			17-35	38	8400	90	-
			22-44	46	10500	90	-
			22-55	58	10500	90	-
1400	217	1.6"-3.1"	3-14.5	17	2800	90	70000
			7-28	30	7000	90	-
			14.5-29	32	14000	90	-
			17-35	38	16800	90	-
			22-44	46	21000	90	-
			22-55	58	21000	90	-
			35-70	73	33600	90	-

ACTUATOR PART LIST

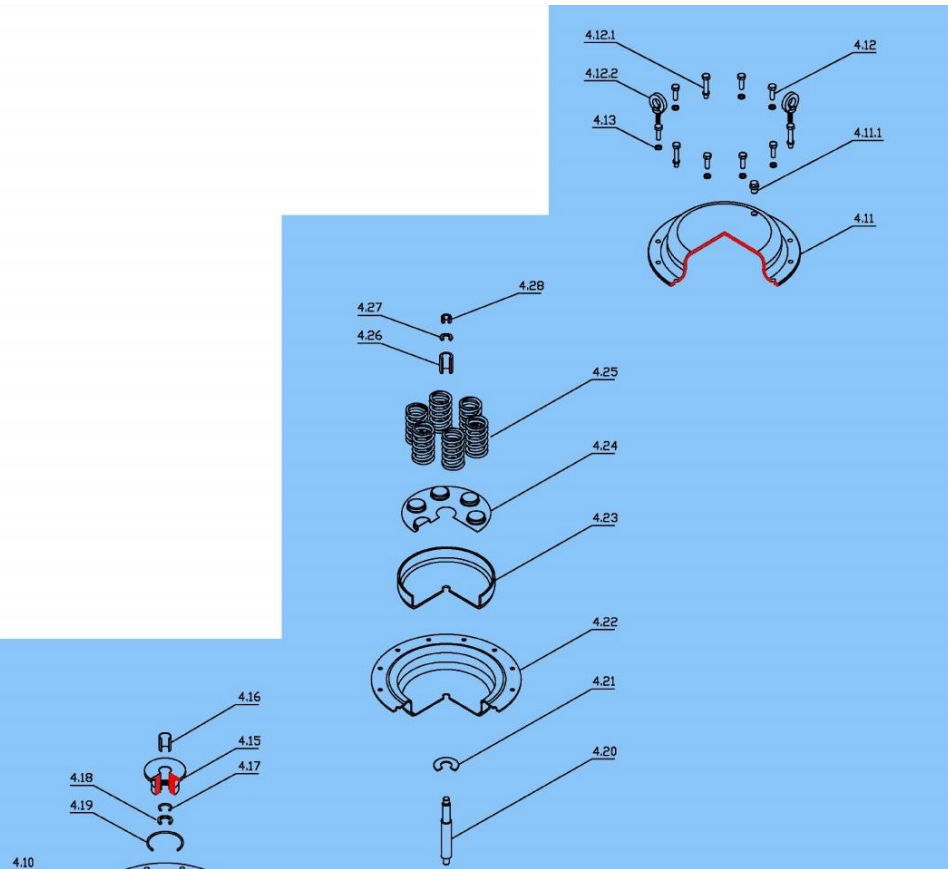

Part Description	Drawing No.	Part No.	Materials ANSI
Diaphragm Casing	4.10	4100-09-410-300	1040
Diaphragm Casing	4.11	4100-09-411-300	1040
Fitting	4.10.1	4100-17-4101-300	BRASS
Vent Fitting	4.11.1	4100-17-4111-300	BRASS
Bolt	4.12	4100-02-412-M8.30	SS-316
Extended Bolt	4.12.1	4100-02-4121-M8.45	SS-316
Eye Bolt (2 1/2" and above)	4.12.2	4100-02-4122-M8.45	1040
Washer	4.13	4100-02-413-M8	SS-316
Nut	4.14	4100-02-414-M8	SS-316
Actuator Bonnet	4.15	4100-09-415-080	1040
Bearing	4.16	4100-15-416-017	PTFE+BRONZE
O-Ring	4.17	4100-15-416-017	NBR 70
O-Ring	4.18	4100-12-417-020	NBR 70
O-Ring	4.19	4100-12-418-020	NBR 70
Shaft	4.20	4100-02-420-020.020	SS-316
Washer	4.21	4100-10-421-080	4140
Membrane	4.22	4100-11-422-300	NBR 60
Bowl	4.23	4100-09-423-300	1040
Spring disc	4.24	4100-09-424-300	1040
Springs	4.25	4100-03-425-30.12.24.2	SS-302
Union	4.26	4100-09-426-030	1040
Washer	4.27	4100-09-427-M16	1040
Nut	4.28	4100-09-428-M16.15	1040

VALVE PART LIST

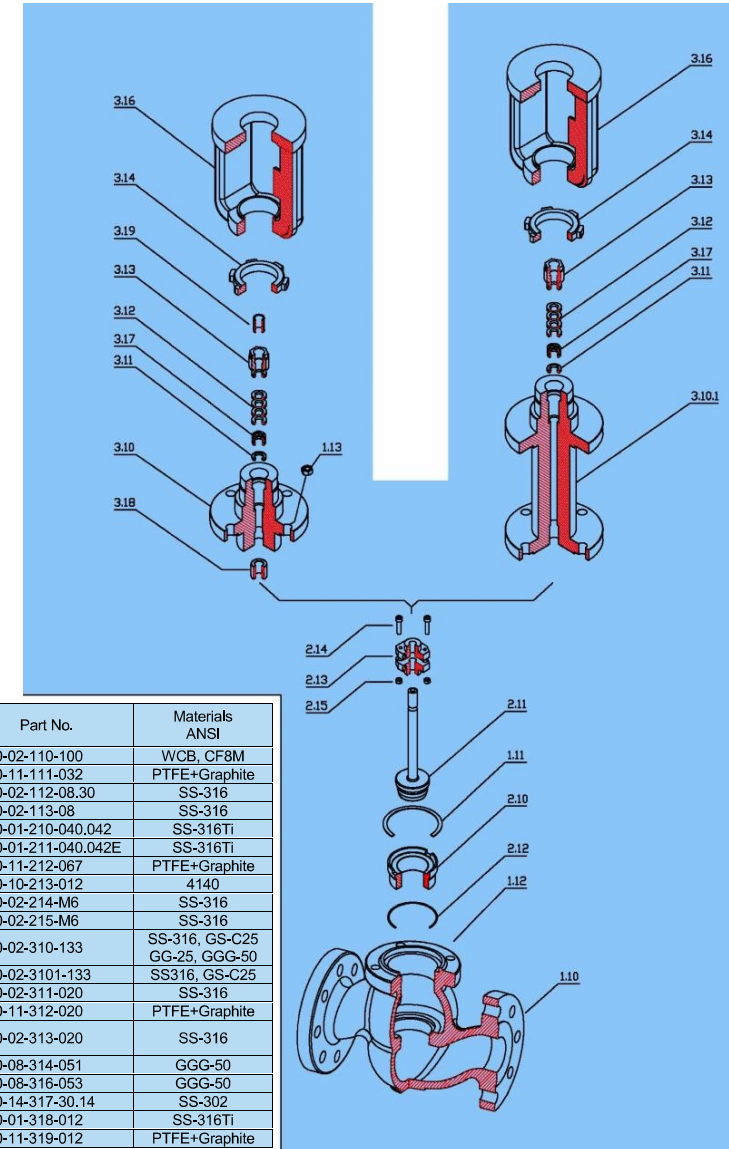

Part Description	Drawing No.	Part No.	Materials ANSI
Body	1.10	4120-02-110-100	WCB, CF8M
Bonnet Washer	1.11	4110-11-111-032	PTFE+Graphite
Stud bolt	1.12	4110-02-112-08.30	SS-316
Nuts	1.13	4110-02-113-08	SS-316
Seat	2.10	4110-01-210-040.042	SS-316Ti
Plug	2.11	4110-01-211-040.042E	SS-316Ti
Seat Washer	2.12	4110-11-212-067	PTFE+Graphite
Connector	2.13	4110-10-213-012	4140
Stud Bolt	2.14	4110-02-214-M6	SS-316
Nuts	2.15	4110-02-215-M6	SS-316
Standard Bonnet	3.10	4110-02-310-133	SS-316, GS-C25 GG-25, GGG-50
Bellows Seal Bonnet	3.10.1	4110-02-3101-133	SS316, GS-C25
Washer	3.11	4110-02-311-020	SS-316
Packing	3.12	4110-11-312-020	PTFE+Graphite
Bonnet packing retainer	3.13	4110-02-313-020	SS-316
Lock nut	3.14	4110-08-314-051	GGG-50
Yoke	3.16	4110-08-316-053	GGG-50
Spring	3.17	4110-14-317-30.14	SS-302
Guide	3.18	4110-01-318-012	SS-316Ti
Guide	3.19	4110-11-319-012	PTFE+Graphite

DIMENSIONS AND WEIGHTS

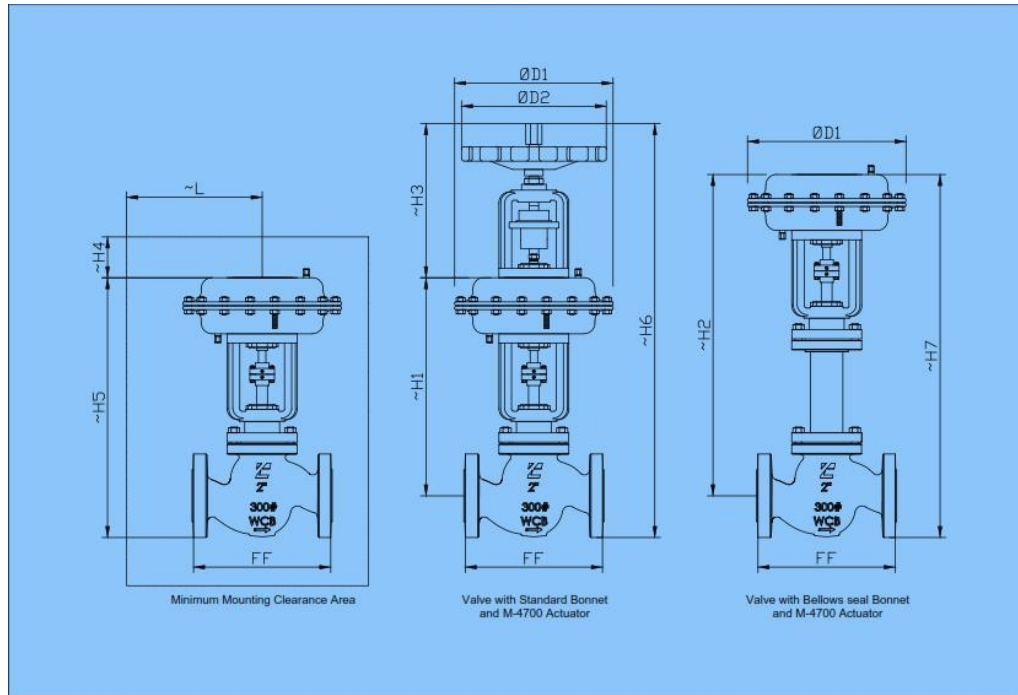

DIMENSIONS AND WEIGHTS

Designations	Ø D1	Ø D2	Nominal Size INCH										
			1/2	3/4	1	1 1/4	1 1/2	2	2 1/2	3	4	6	8
			Stroke = 0.8"						1.6"	1.8"	2.7"	3.1"	
FF Face to Face Dimensions			6	7	8	8.5	9	10.5	11.5	12.5	14	17.5	22
H1 for Standard Bonnet (in)	M-4700 / 300	Ø11.6	Ø7.9	13.3	13.5	13.7	14.3	14.5	14.8				
	M-4700 / 450	Ø13.8	Ø9.8					19.2	19.0	19.3	20.0	23.8	
	M-4700 / 700	Ø16.6	Ø13.8						21.2	21.6	22.2	26.1	31.3
	M-4700 / 1400	Ø16.6	Ø13.8										40.1
-Weight in lb for Standard Bonnet, without accessories	M-4700 / 300			46.3	50.7	52.9	68.3	72.7	79.3				
	M-4700 / 450								110.2	154.3	165.3	209.4	440.9
	M-4700 / 700									180.8	194.0	229.3	749.5
	M-4700 / 1400												903.9
-H2 for Bellows seal Bonnet (in)	M-4700 / 300	Ø11.6	Ø7.9	21.4	21.6	21.8	22.4	22.6	22.9				
	M-4700 / 450	Ø13.8	Ø9.8							27.1	27.4	28.1	31.9
	M-4700 / 700	Ø16.6	Ø13.8							29.4	29.7	30.0	34.2
	M-4700 / 1400	Ø16.6	Ø13.8										55.0
-Weight in lb for Bellows seal Bonnet, without accessories	M-4700 / 300			52.9	57.3	59.5	77.1	83.7	92.6				
	M-4700 / 450									174.1	185.1	224.8	449.7
	M-4700 / 700									200.6	213.8	249.1	758.3
	M-4700 / 1400												912.7
-H3 for Hand Wheel (in)	M-4700 / 300	Ø11.6	Ø7.9	14.5	14.5	14.5	14.5	14.5	14.5				
	M-4700 / 450	Ø13.8	Ø9.8							14.5	14.5	14.5	17.7
	M-4700 / 700	Ø16.6	Ø13.8							14.5	14.5	14.5	17.7
	M-4700 / 1400	Ø16.6	Ø13.8										17.7
-Weight in lb with Hand Wheel, without accessories	M-4700 / 300			72.7	77.1	79.3	94.8	99.2	105.8				
	M-4700 / 450									180.7	191.8	235.9	471.8
	M-4700 / 700									207.2	220.4	260.1	793.6
	M-4700 / 1400												947.9
-L for minimum mounting clearance area (in)	M-4700 / 300	Ø11.6	Ø7.9	11.2	11.2	11.2	11.2	11.2	11.2				
	M-4700 / 450	Ø13.8	Ø9.8							13.9	13.9	13.9	15.1
-H4 Removal space for actuator 6.9 in	M-4700 / 700	Ø16.6	Ø13.8							15.7	15.7	15.7	18.9
	M-4700 / 1400	Ø16.6	Ø13.8										18.9
-H5 with Standard Bonnet overall dimension (in)	M-4700 / 300	Ø11.6	Ø7.9	16.8	17.2	17.6	18.7	19.1	19.6				
	M-4700 / 450	Ø13.8	Ø9.8							24.2	24.8	26.2	31.3
	M-4700 / 700	Ø16.6	Ø13.8							26.5	27.1	28.5	33.6
	M-4700 / 1400	Ø16.6	Ø13.8										47.6
-H6 with Hand Wheel overall dimension (in)	M-4700 / 300	Ø11.6	Ø7.9	30.6	31.0	31.4	32.4	32.8	33.4				
	M-4700 / 450	Ø13.8	Ø9.8							38.0	38.6	40.0	46.0
	M-4700 / 700	Ø16.6	Ø13.8							40.3	40.9	42.3	48.3
	M-4700 / 1400	Ø16.6	Ø13.8										58.2
-H7 with Bellows seal Bonnet overall dimension (in)	M-4700 / 300	Ø11.6	Ø7.9	23.3	23.7	24.1	25.1	25.5	26.1				
	M-4700 / 450	Ø13.8	Ø9.8							30.7	31.3	32.7	37.8
	M-4700 / 700	Ø16.6	Ø13.8							33.0	33.6	35.0	40.1
	M-4700 / 1400	Ø16.6	Ø13.8										62.9
Flange Drilled and Dimensioned acc. to			ASME B16.10										